

ARMORLITE

TECHNOLOGIES INC

RT 2.0

OPERATORS MANUAL

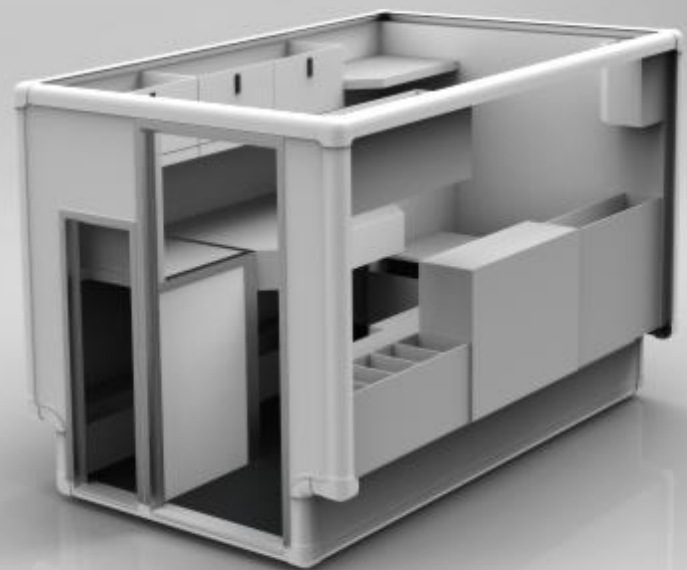

2015 V1.0

Table of Contents

PREFACE	2
PRODUCT INFORMATION	3
PRODUCT WARRANTY	4
IMPORTANT INFORMATION	5
BOLT DOWN INFORMATION	6
CO MONITOR / 120VAC BREAKER	8
ELECTRICAL	9
PLUMBING AND HEATING	12
DRYER OPERATION	13
CARE AND MAINTENANCE	14
SPECIFICATIONS	15
REPLACEMENT PARTS	16

Preface

Thank you for choosing Armorlite Tech Inc, please read the following general information prior to usage.

1. This guide will provide you with information and specific instructions for the basic care of your unit(s).
2. Please note **WHEN ORDERING PARTS**, you should check the most up-to-date information as parts / part numbers may be subject to change.
3. Specifications subject to change and no guarantee/ warranty implied to its accuracy as materials and parts updated as required.

Contact us at

780-454-2766
armorlitetech.com

67 15-76 Avenue
Edmonton, Alberta
T6B 0A9

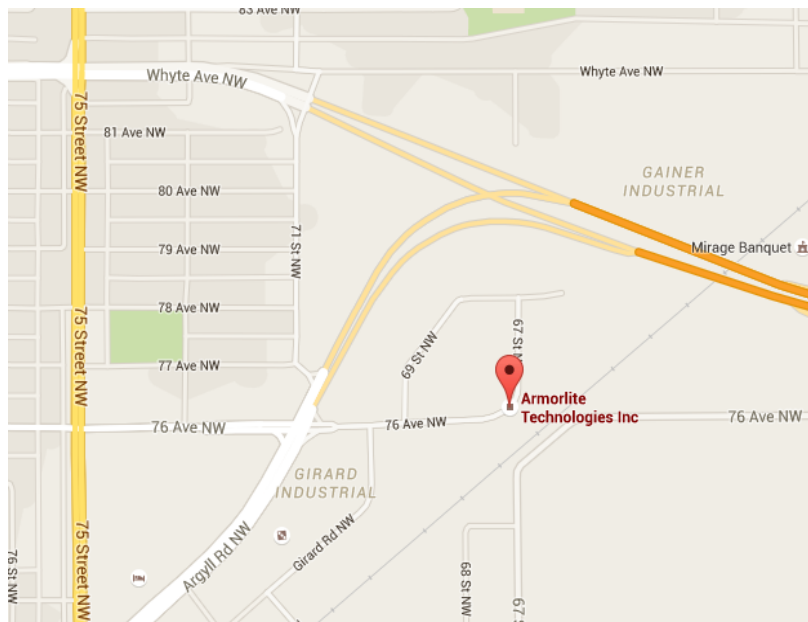

Product Information

Your serial number is located on the inside of the main door frame near the floor on the drivers side. The picture below illustrates the position of the serial number and the way it can be read.

The specific information of your lab is listed in the table below.



Serial # Location

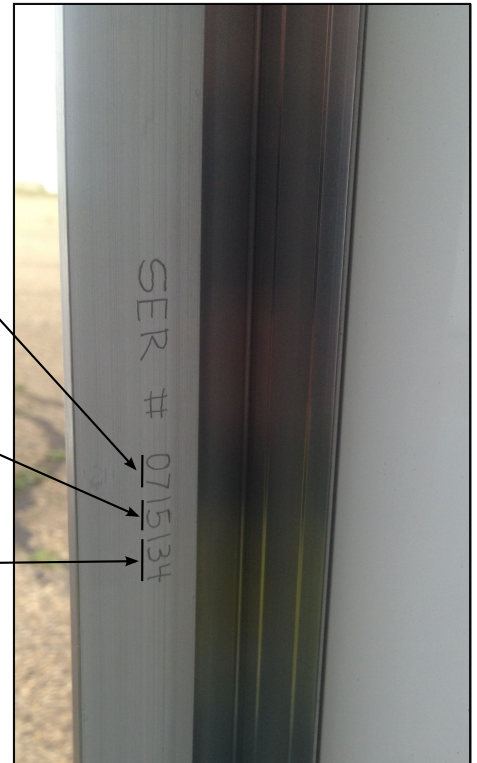

**Month unit
manufactured**

**Year unit
manufactured**

Unit number

INFO

Note : Pictured serial number (above) is for reference only, your unit specific serial number is listed in the form below.

Serial Information	
Serial No :	_____
Company / Owner Name :	_____
Date Installed :	_____
Approval :	_____

LIFETIME STRUCTURAL WARRANTY

Armorlite Technologies uses the highest grade of materials and utilizes quality control measures that provide an extremely durable, long lasting product. These provide our customers with a worry free lifetime warranty.



What is covered

Defects in materials or workmanship for structure of unit, primary and secondary extrusions, corner caps, panel delamination, cracks and separations in outer structure of unit.

Duration of coverage

Warranty runs for the life of the product to the original purchaser.

What is not covered

Doors, hinges, latches, interior components, motors, blowers, heaters and cabinetry all of which are covered by our one year warranty protection against materials and workmanship. Paint peeling, flaking, fading and scratches not covered.

Conditions

- Damage caused by misuse, negligence, accidents, improper installation, acts of nature, or holes and openings not approved by manufacturer.
- Lack of maintenance or improper accessory installation not covered by any warranty whatsoever.
- Serial number defacement or alteration voids warranty.
- Manufacturer does not accept responsibility to purchaser for warranty expressed or implied by any of its dealers, agents or distributors.
- Incidental and consequential damages are expressly disclaimed.
- All fasteners and screws should be stainless steel, not zinc coated steel, to reduce galvanic corrosion which is not covered by warranty.

Armorlite reserves the right to accept or deny warranty at its own discretion.

Important Information

- Signs shall have sealed load spreading rivets and follow a minimum 4" increment from edge.
- Holes and mounting to be minimum 4" from all edges and shall be approved by Armorlite Technologies Inc.
- Locations during mounting of the unit(s) must be approved by Armorlite Technologies Inc.
- Replacement part(s) must be approved or manufactured by Armorlite Technologies Inc.
- Changes, modifications and add-ons to the electrical components in the unit(s) must be completed or approved by Armorlite Technologies. Failure to do so will cause the termination of this warranty.

Bolt Down Procedure

IMPORTANT INFORMATION

C1. LOCATION DURING MOUNTING OF THE UNIT(S) MUST BE APPROVED BY ARMORLITE TECHNOLOGIES INC.

C2. REPLACEMENT PART(S) APPROVED OR MANUFACTURED BY ARMORLITE TECHNOLOGIES INC

- 1) Determine lab positioning in truck box, mark desired bolt locations (4). Ensure bolts will not interfere with critical truck components and you have access to bottom side of bolts before drilling.
- 2) Drill 1/2" hole through lab floor and truck bed at marked locations (4).
- 3) Drill 7/8" holes through lab floor only, insert supplied crush sleeve (approx. .82" OD x .54" ID aluminum tube) into hole and bottom against floor of truck bed, ensure fully seated and mark sleeve at lab floor. Cut sleeve 1/32" to 1/16" LESS that mark to allow adequate clamping force without compressing floor excessively.
- 4) Install precut sleeves and 1/2" bolts with 3" (minimum) load spreading washers or plates on lab floor side and under truck bed side. Use self locking nuts or lockwashers on bottom side.
- 5) Tighten bolts securely, inspecting floor for proper compression. Floor should NOT be compressed more than 1/16".

It is highly recommended to use frame brackets to attach lab to vehicle frame directly rather than box alone as under severe conditions lab can potentially pull through floor of truck box causing personal injury and/or property damage.

Notes:

Refer to figure 1.1 - 1.2 (on next page)

Length of sleeve depends on "valley" of truck bed floor. Upper rise or flat deck length of sleeve should be 2.160" +/- .080"

The length of "valley" in floor is determined by truck box and calculated using steps above.

Please use 1/2" schedule 80 aluminum pipe (0.82"OD x 0.54"ID) as crush sleeve material.

Bolt Down Procedure

Crush sleeves MUST be used to prevent damaging core structure of floor. Warranty will NOT cover damage caused by improper mounting procedures.

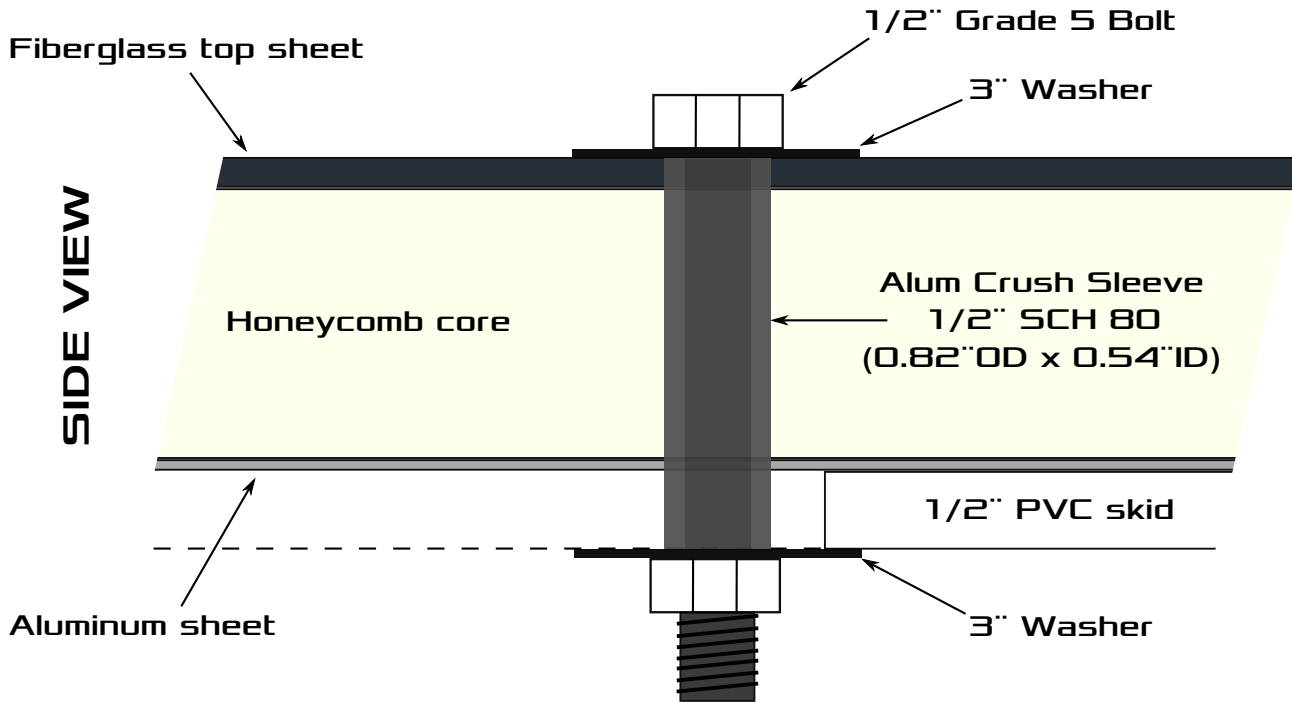

figure 1.1

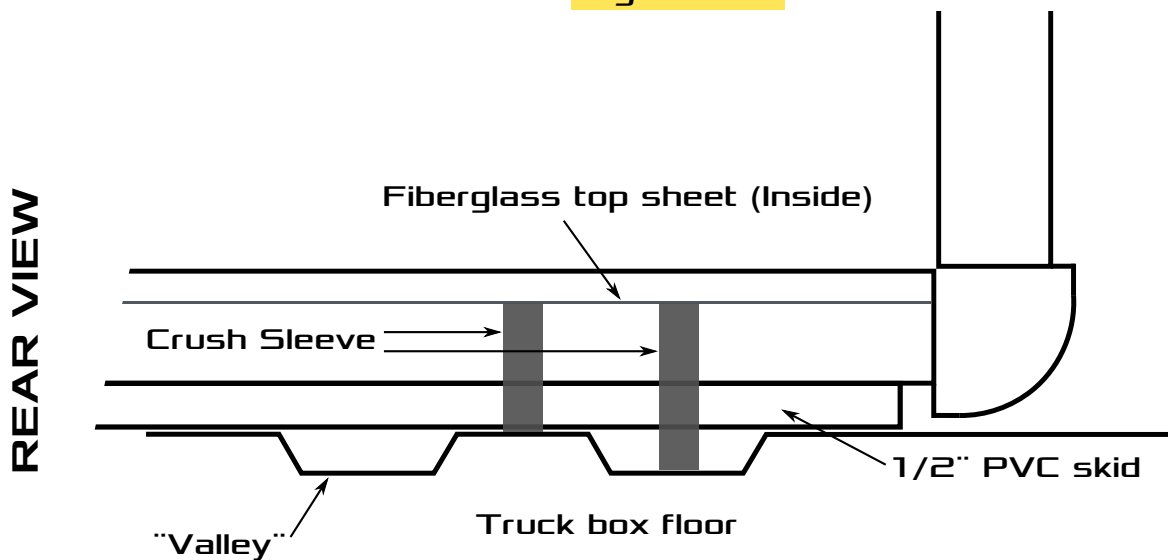

figure 1.2

For questions / concerns or technical assistance contact Armorlite Technologies Inc directly at: 780-454-2766.

INSTALL

Electrical

C/O MONITOR

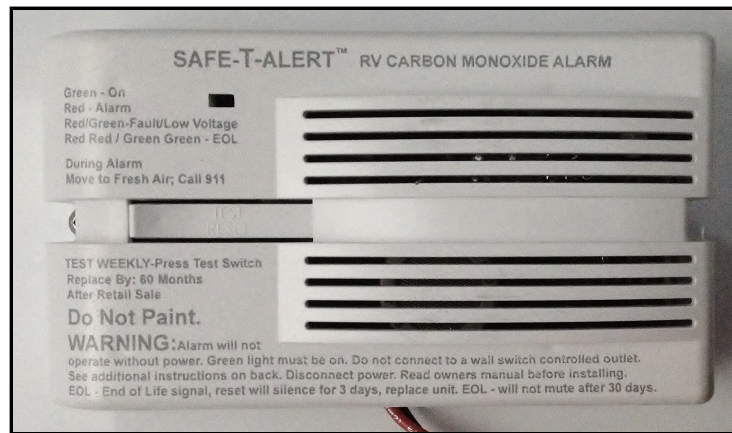

Your unit has been equipped with a 12 VDC carbon monoxide monitor for your safety. Periodic testing of unit and ensuring proper operation protects against harmful and potentially fatal carbon monoxide poisoning. Do NOT unplug, disable or remove this safety device. If there is an issue with unit please contact Armorlite Technologies Inc directly for diagnosis/repair or replacement.

120 VAC BREAKER

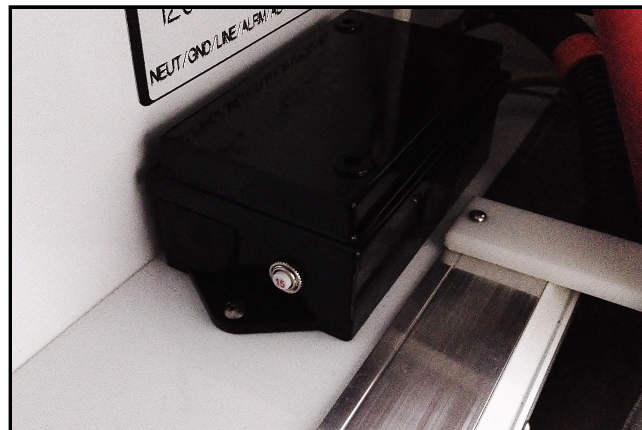

Your unit is also fitted with a 120 VAC breaker to protect the wiring inside the lab from high current damage. The breaker is found mounted to the side of the black electrical box (under the main bench). If the breaker trips it can be reset by depressing the white button on the side of the electrical box. The box does NOT need to be opened to reset the breaker.

When supplying external 120VAC power to unit, electrical cord and outlet must have functioning ground connections present.

Electrical

LEGEND

- S/L - Safe Light
- HTR - 12v Heater
- INT - Intake Fan
- A/C - Optional A/C System
- FAN - Optional A/C Fan
- W/L - White Light

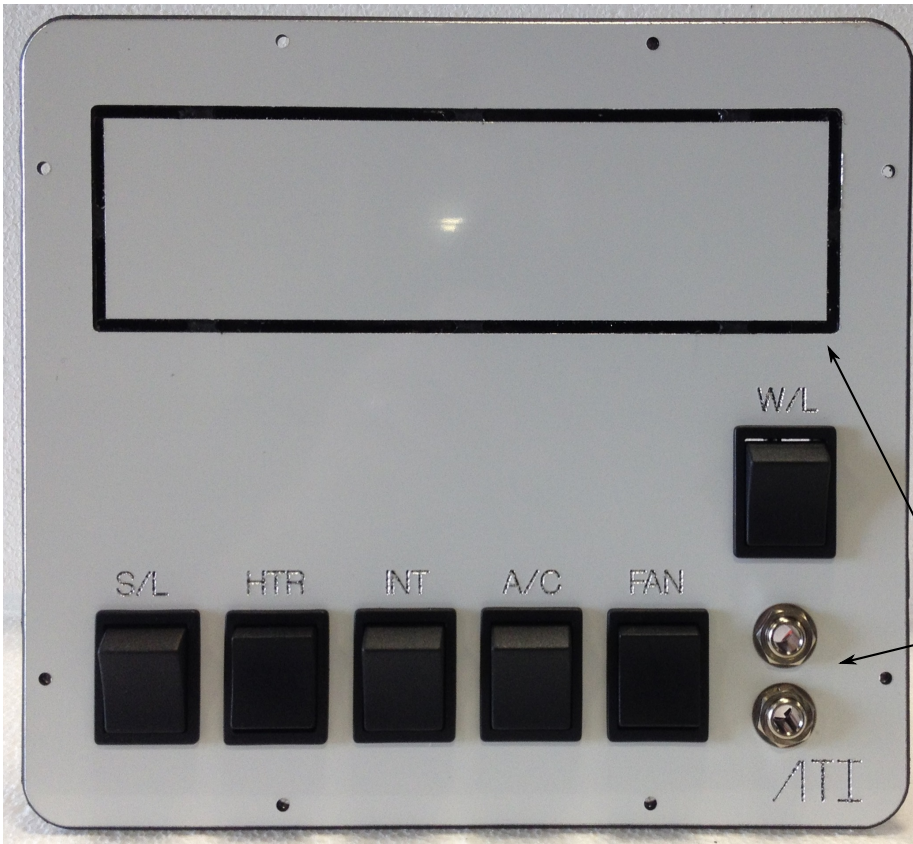

Optional Climate Controller

12v Jacks

LEGEND

- SPOT - Spot Light
- BCN - Beacon
- AUX - Optional Switch

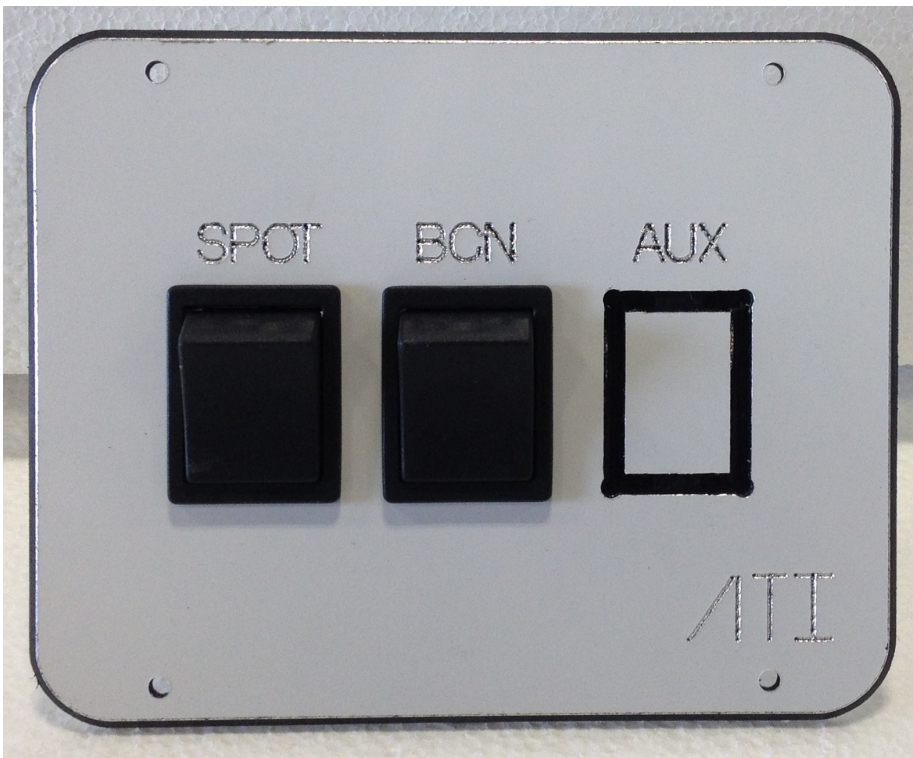

ELECTRICAL

Electrical

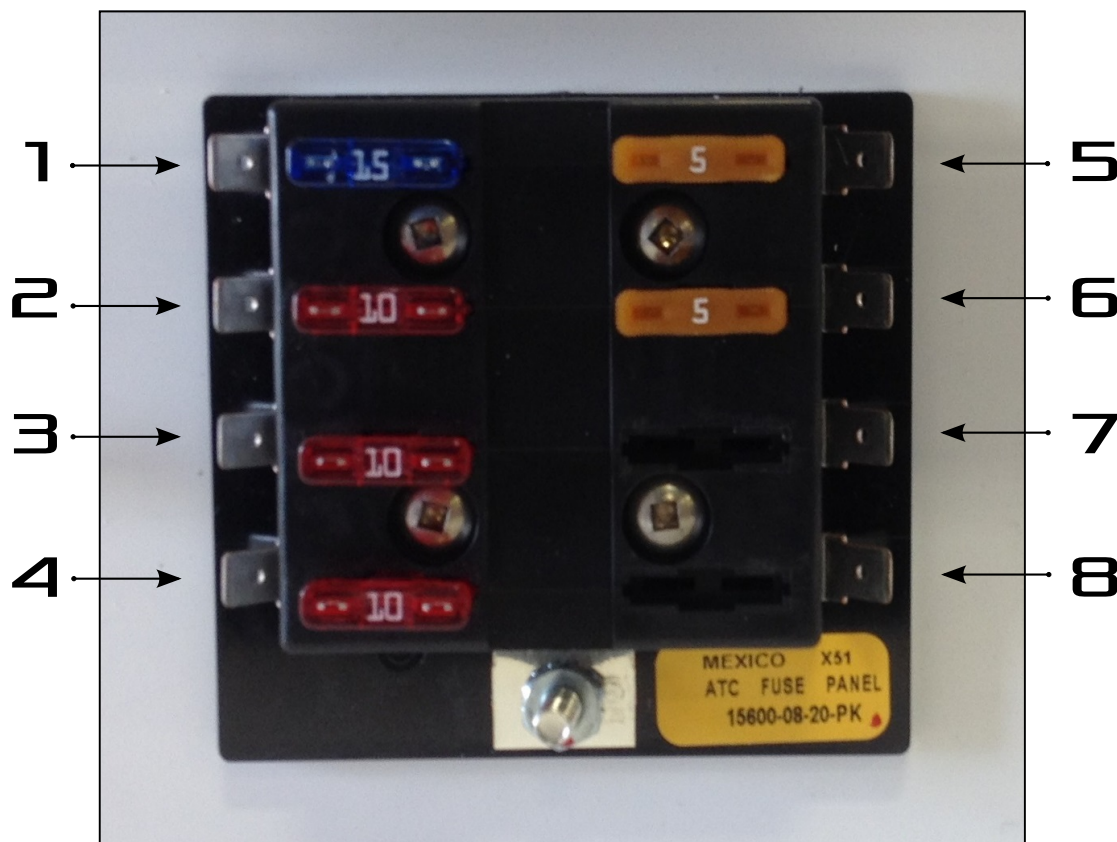

FUSE LOCATION

- | | |
|----------------------------|---------------------------------------|
| 1. - 15A 12v Jacks | 5. - 5A White Light Safe Light |
| 2. - 10A Intake Fan | 6. - 5A C/O Detector |
| 3. - 10A Heater | 7. - 20A A/C Unit |
| 4. - 10A Aux Panel | 8. - XX AUX |

ELECTRICAL

Electrical

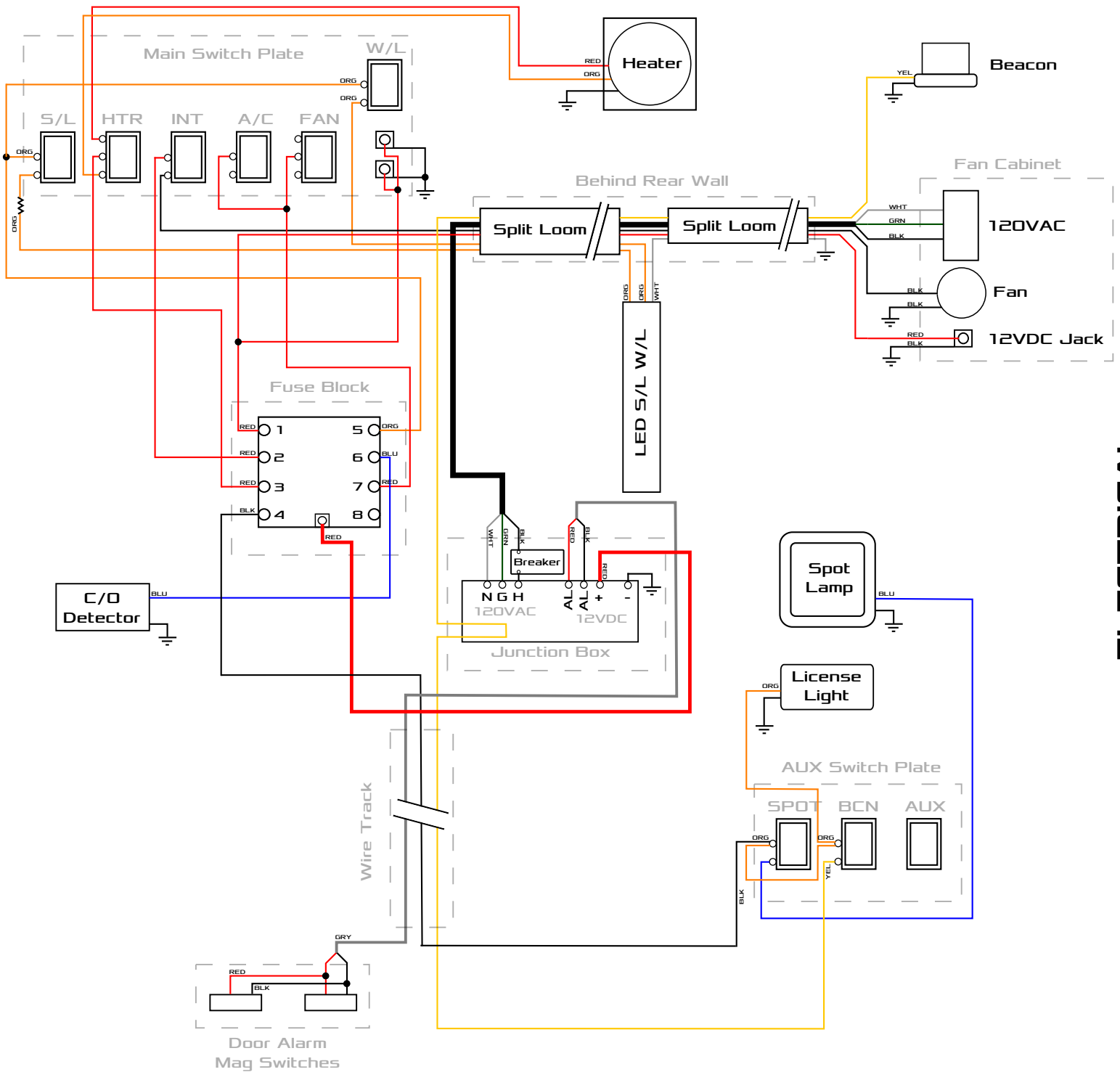

ELECTRICAL

Plumbing

Your unit is equipped with 2 shutoff valves for controlling coolant flow to the heater and chill chaser. The valves are located next to the chill chaser and next to the heater (pictured below). Moving either to the open or closed position will allow temperature regulation to the heater or chill chaser.

The plumbing system has been built from solid copper and attached to the unit with CNC cut mounting brackets for zero maintenance and long term reliability.



Chill chaser valve shown
in the open position

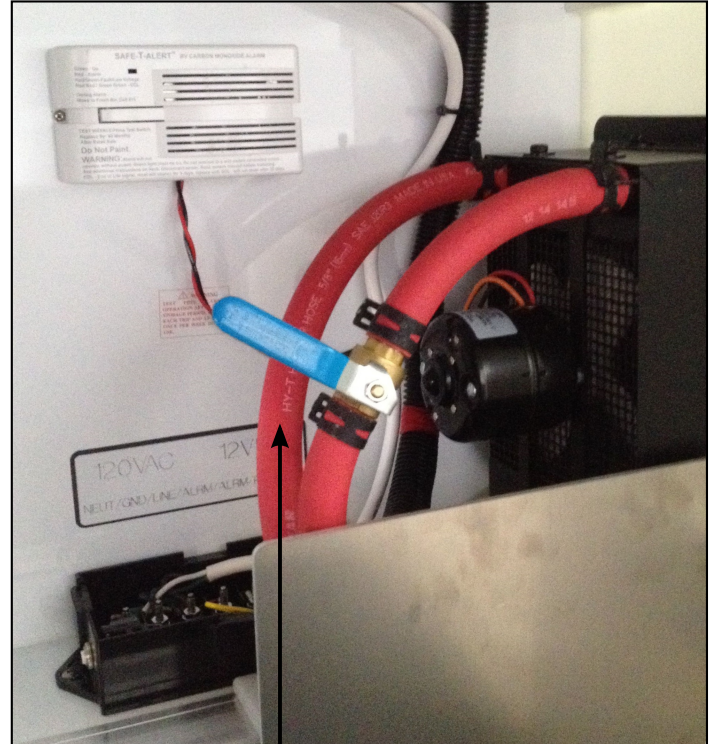

Heater valve shown in
the closed position

Dryer Operation

Your lab is specifically equipped with a passive ventilation system controlling dryer airflow. This reduces maintenance and increases reliability. While drying your film you have multiple options:

- Turning heater on "low" forces moist air out of the bottom of dryer while getting its replacement air from the intake vents.
- Turning the heater on "high" provides the same operation with increased airflow.
- The other option is turning the intake fan on which effectively pressurizes the lab forcing moist air out through the dryers lower vents (the lids do not need to be open for this function). Using this in combination with the 12VDC heater will produce faster forced drying and should be adjusted to suit operators needs / requirements.
- Temperature regulation is controlled using the heaters ball valve. Adjusting this valve changes the temperature of air going into dryer.

Drain / Air Outlets
(Inside Dryer)

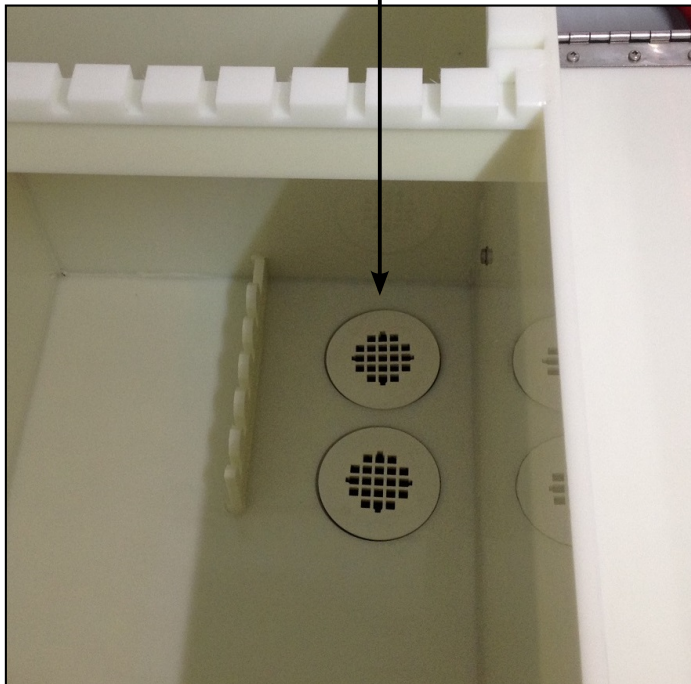

Drain / Air Outlets
(Outside Unit)



PLUMBING

Care and Maintenance

IMPORTANT INFORMATION

Many cleaning products/agents can be potentially hazardous; some may be poisonous and flammable. Always follow the instructions on the container. Please allow for proper ventilation when cleaning the interior. Never use fluids or solvents that are not designed for cleaning. Always lock away cleaning products and keep them out of reach of children.

Maintenance

- Silicone or teflon spray all door lock cylinders, rotary latches, etc. to prevent corrosion and extend life.
- Door hinges should be oiled periodically to aid in smooth operation and extend service life.
- The latching position of the main door rotary can be adjusted via the access hole in the door side. This adjustment sets the release travel of the main door handle.

General cleaning

- Use a clean soft bristle brush or cloth to clean exterior.
- Use a mild cleaning agent.
- Rinse the unit with clean water and dry thoroughly with a dry microfiber cloth.
- Do not allow cleaning agent(s) to dry on the exterior/interior surfaces.
- When using the unit in winter remove all traces of road salt deposits carefully and as soon as practical.
- Applying automotive wax annually will greatly improve longevity of painted surfaces, keep unit cleaner and prevent staining (highly recommended).
- Remove dirt as soon as practical, when possible avoid scrubbing with force.
- After extended road trips in adverse conditions, the rear of the lab is exposed to excessive up-spray causing corrosion to form if not removed.

For additional information or replacement parts contact Armorlite Technologies Inc directly at : 780-454-2766.

Specifications

INFO

Long Box Specs
Height - 63"
Width - 60"
Length - 99"
Int Height - 60"
Int Width - 56"
Int Length - 93"
Weight - 790 lbs

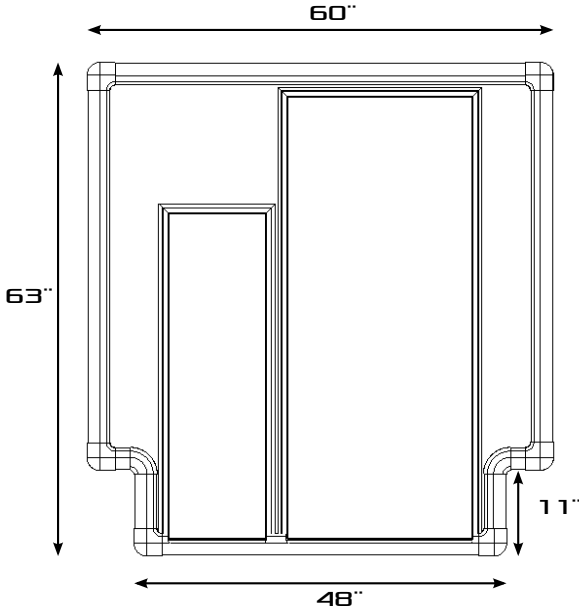

Short Box Specs
Height - 63"
Width - 60"
Length - 81"
Int Height - 60"
Int Width - 56"
Int Length - 74"
Weight - 690 lbs

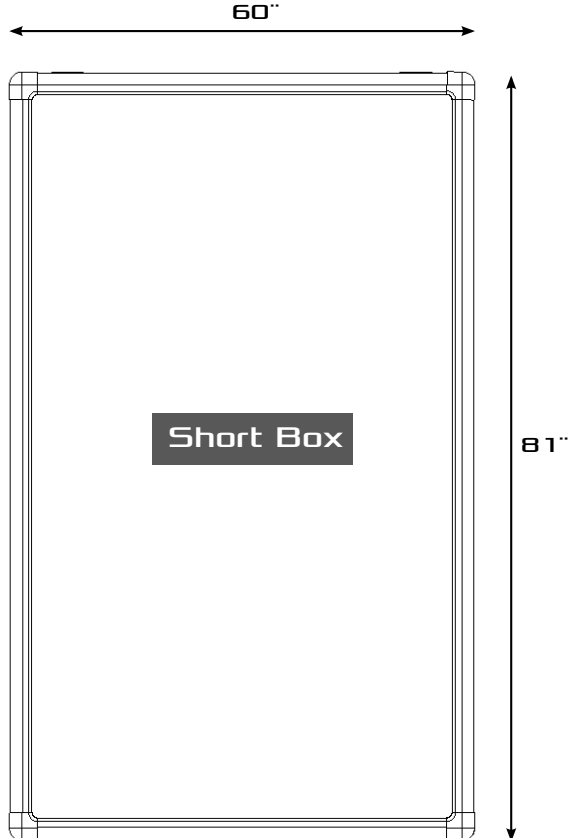
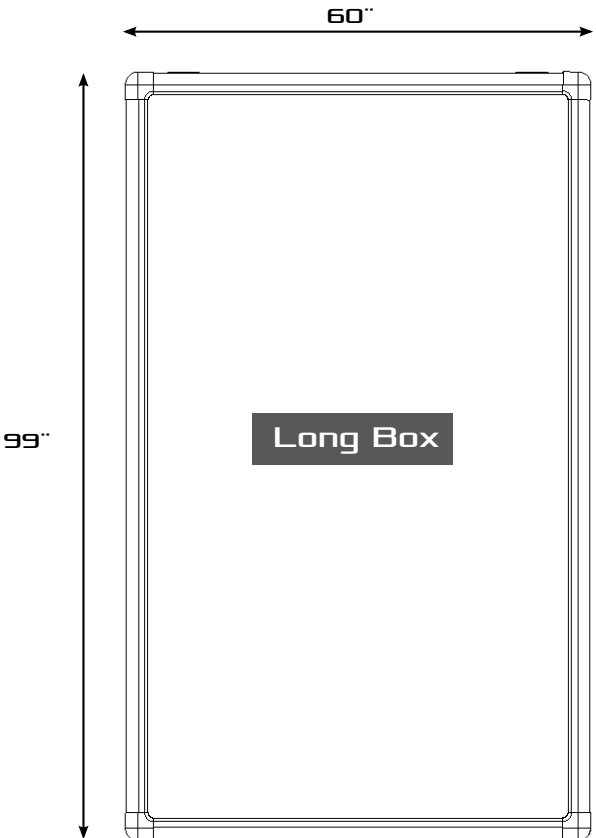

Replacement Parts

Description	Part No.
Bulb Weather Strip	6234478
T-Handles	6970453
Beacon Light	STB-A34
Interior LED Light	ATI-LEDRT
Switch ST/DP	EG 1524-ND
Switch DT/DP	EG 1539-ND
12VDC Jacks	SC 1317-ND
Ball Valves	0541133
Cabinet Latches	634-30
Intake Blower	35515-0010
Heater Hose 5/8"	GYR65025
12VDC Heater	ED-R254-OP
CO Detector	COMM

INFO

ALL FASTENERS AND SCREWS SHOULD BE STAINLESS STEEL NOT ZINC COATED STEEL TO REDUCE GALVANIC CORROSION WHICH IS NOT COVERED BY WARRANTY.